



**O'SHEA**  
PLANT HIRE

**ALU-FRAMAX**



# CONTENTS

## PAGE No:

### INTRODUCTION

The advantages of using the system.

1

### IN PRACTICE

An example of the Alu-Framax panels once erected.

2

### TYPICAL DESIGN

An example of a panel layout.

3

### COMPONENTS

Standard Panels

Universal Panels

Framax Stripping Corner

4

Hinged Inside Corner

Hinged Outside Corner

Standard Outside Corner

Standard Inside Corner

5

### ACCESS AND ALIGNMENT

540/340 Alignment Struts

90° Access Bracket

Column Corner Platform

K-Platform

6

### ACCESSORIES

Multifunction Clamp

Quick Acting Clamp

Wedge Clamp

Stop End Tie

Crane Lifting Hook

Fixing Bolt 10-25cm

0.9m Uni Waling

1.5m Uni Waling

Corner Waling

7

# INTRODUCTION

- A** The Alu-Framax panel is a highly versatile and key component to the Alu-Framax system. Varied panel sizes and interconnectivity between the panels make even the most unusual shapes easy to form. The total weight of the individual panels is another key feature of the system. The largest panel weighs only 68kg making it very easy to re-locate and re-use around site by hand, where crane operations are not always practical, whilst still retaining a permissible fresh concrete pressure of 60kN/m<sup>2</sup>.
- B** Quick acting clamps are used to join the Alu-Framax panels together to create a fast, self-aligning and tensile joint. In addition, they have been designed to be hard wearing with no separate loose parts.
- C** Wedge Clamps are used to fasten accessories such as universal walings into the intergrated waling system on the panel.
- D** Timber infills can be used in conjunction with the multifunction clamps and universal walings for infills between 10-150mm.
- E** The outside corners are an easy way of forming corners in narrow trench situations or where large wall thicknesses are called for.
- F** The hinged corner allows for corners between 90° and 180° to be constructed and can also be fixed at a 90° angle using a universal fixing bolt.
- G** Stop end ties are used in conjunction with universal walings, knock on wing nuts, waler plates and timber to form stop ends.
- H** Plumbing struts provide a quick and easy method of alignment.
- I** Pouring and access platforms are available. These attach quickly and easily to provide a safe working area.
- J** The column-platform is a pre-assembled, ready-to-use platform that ensures convenient and safe working on column formwork.
- K** The universal range of panels are unique versions of the standard panels, capable of maintaining a permissible fresh concrete pressure of 90kN/m<sup>2</sup>. Universal panels can be used in situations that require a higher resistance to pressure or when ties are required in positions not offered on the standard panels.

# IN PRACTICE

PAGE 2  
IN PRACTICE

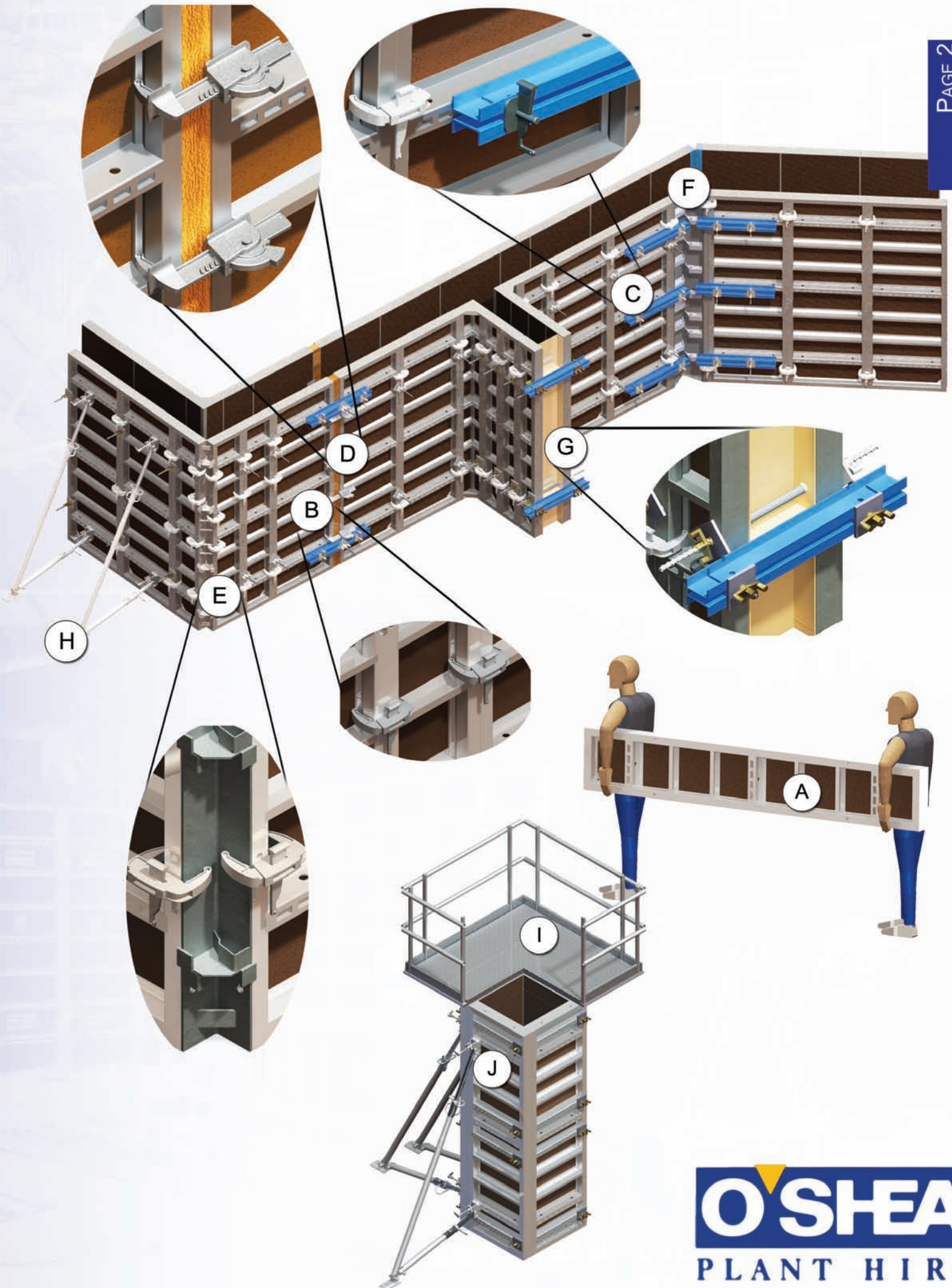



# COMPONENTS



## STANDARD PANEL

Description	Weight(Kg)	Stock Code
0.90 x 2.70m	68.80	102000
0.75 x 2.70m	55.70	102070
0.60 x 2.70m	47.80	102600
0.45 x 2.70m	40.10	102010
0.30 x 2.70m	30.00	102060
0.90 x 0.90m	25.60	102052
0.75 x 0.90m	21.60	102048
0.60 x 0.90m	17.80	102050
0.45 x 0.90m	15.40	102046
0.30 x 0.90m	11.50	102044



## INSIDE STRIPPING CORNER

Description	Weight(Kg)	Stock Code
1.35m High	90.00	102083
2.70m High	171.50	102081
3.30m High	211.80	102079



## UNIVERSAL PANEL

Description	Weight(Kg)	Stock Code
0.75 x 2.70m	64.20	102022
0.75 x 0.90m	27.00	102020

# COMPONENTS



## OUTSIDE CORNER

Dimensions	Weight(Kg)	Stock Code
2.7m High	47.00	102082
0.9m High	16.00	102084

PAGE 5  
COMPONENTS

## HINGED OUTSIDE CORNER

Dimensions	Weight(Kg)	Stock Code
2.7m High	52.80	107074
0.9m High	17.60	102075

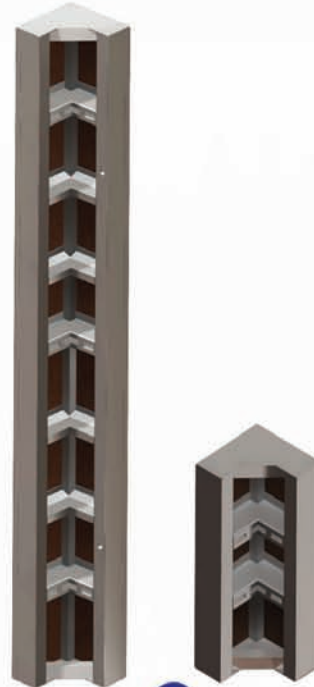

## INSIDE CORNER

Dimensions	Weight(Kg)	Stock Code
2.7m High	50.30	102080
0.9m High	18.50	102078

## HINGED INSIDE CORNER

Dimensions	Weight(Kg)	Stock Code
2.7m High	102.30	102076
0.9m High	38.80	102077

# ACCESS AND ALIGNMENT



## ALIGNMENT STRUTS

Description	Weight(Kg)	Stock Code
540 Strut	49.00	102902
340 Strut	30.20	102900



## 90° BRACKET

Description	Weight	Stock Code
90° Bracket	12.50	102320



## K PLATFORM

Description	Weight(Kg)	Stock Code
Bracket	53.00	101900
3.0m Platform	300.60	101600
4.5m Platform	444.50	101602

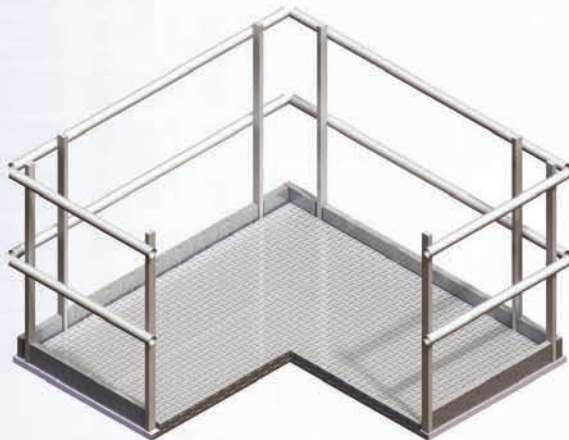

## COLUMN CORNER

Description	Weight(Kg)	Stock Code
Corner 150/90cm	211.80	102330

PAGE 6  
ACCESS + ALIGN



# ACCESSORIES



## MULTI-FUNCTION CLAMP

Description	Weight(Kg)	Stock Code
Multi-Function	5.20	102250



## QUICK ACTING CLAMP

Description	Weight(Kg)	Stock Code
Quick Acting Clamp	3.30	102100

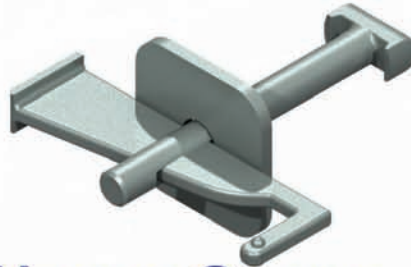

## WEDGE CLAMP

Description	Weight(Kg)	Stock Code
Wedge Clamp	1.50	102260

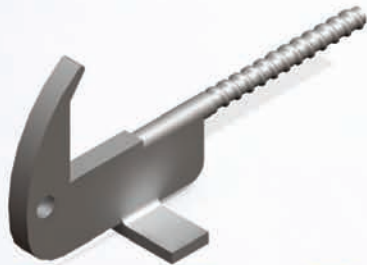

## STOP END TIE

Description	Weight(Kg)	Stock Code
Stop End Tie	1.50	102300



## CRANE LIFTING HOOK

Description	Weight(Kg)	Stock Code
Crane Lifting Hook	10.60	102500

PAGE 7  
ACCESSORIES

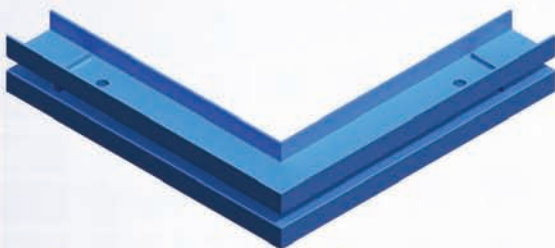

## CORNER WALING

Description	Weight(Kg)	Stock Code
Corner Waling	12.80	102210



## UNIVERSAL WALING

Description	Weight(Kg)	Stock Code
0.9m Uni-Waling	10.60	102200
1.5m Uni-Waling	16.80	102202



## FIXING BOLT 10-25CM

Description	Weight(Kg)	Stock Code
Fixing Bolt 10-25cm	0.69	102272

# WHERE ARE WE?

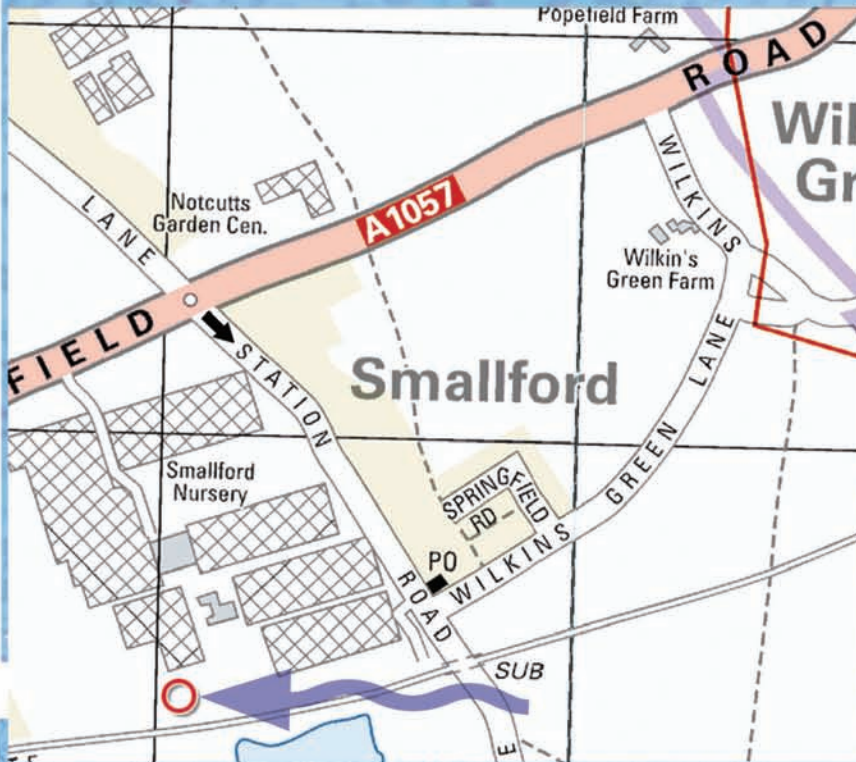

Find us at:  
 Station Road  
 Smallford  
 Nr St Albans  
 Hertfordshire  
 AL4 0HF

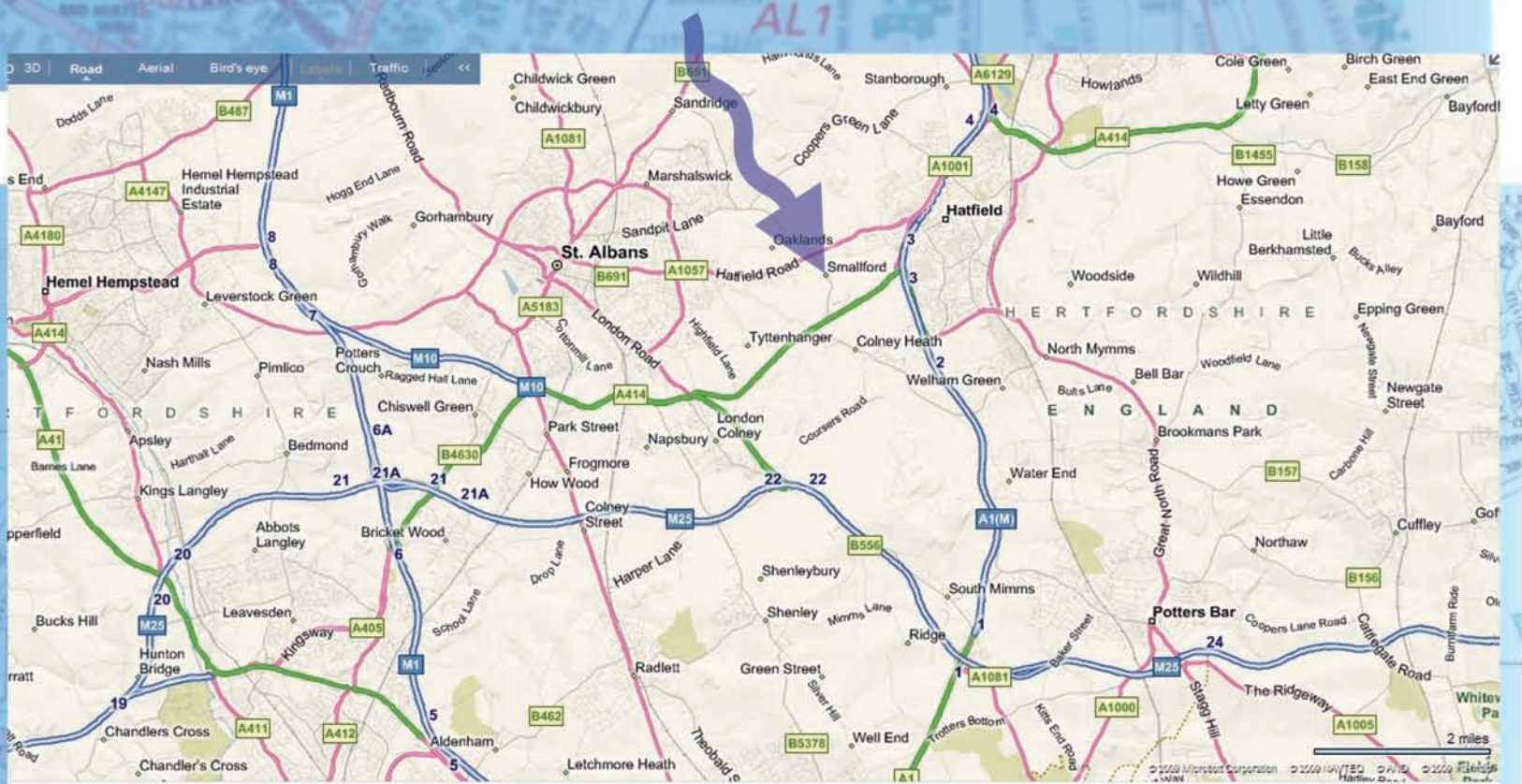

Telephone: 01727 826748

Fax: 01727 826880

<http://www.osheaplanthire.co.uk>

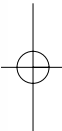
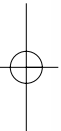
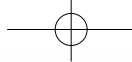

## **Terms and Conditions**

Any unauthorised copying, disclosure or distribution of this brochure or any of its contents is strictly prohibited. The information and details contained within this brochure remains the sole property CJ O'Shea (Plant Hire) Ltd and/or any relevant external sources and is not to be altered or reproduced without prior permission. CJ O'Shea (Plant Hire) Ltd reserves the right to change any information contained within this brochure without giving prior notice.

## **Disclaimer**

The pictures, diagrams and examples used in the booklet are purely for illustration. They are for demonstration only and must not be used for any other purpose.

All information is correct at time of printing and in accordance with manufacturer's technical data.

